



MODELS 29/29B/29L/29BL

Extra Narrow, Heavy Duty Cylinder Bed Machines

SINGLE NEEDLE
12" or 18" CYLINDER ARM
SHOE REPAIR AND MENDING
LOCKSTITCH MACHINE

PARTS LIST



Model 29

Since 1898
CONSEW
MODEL 29

SPARE PARTS LIST FOR SHOE REPAIR MACHINE

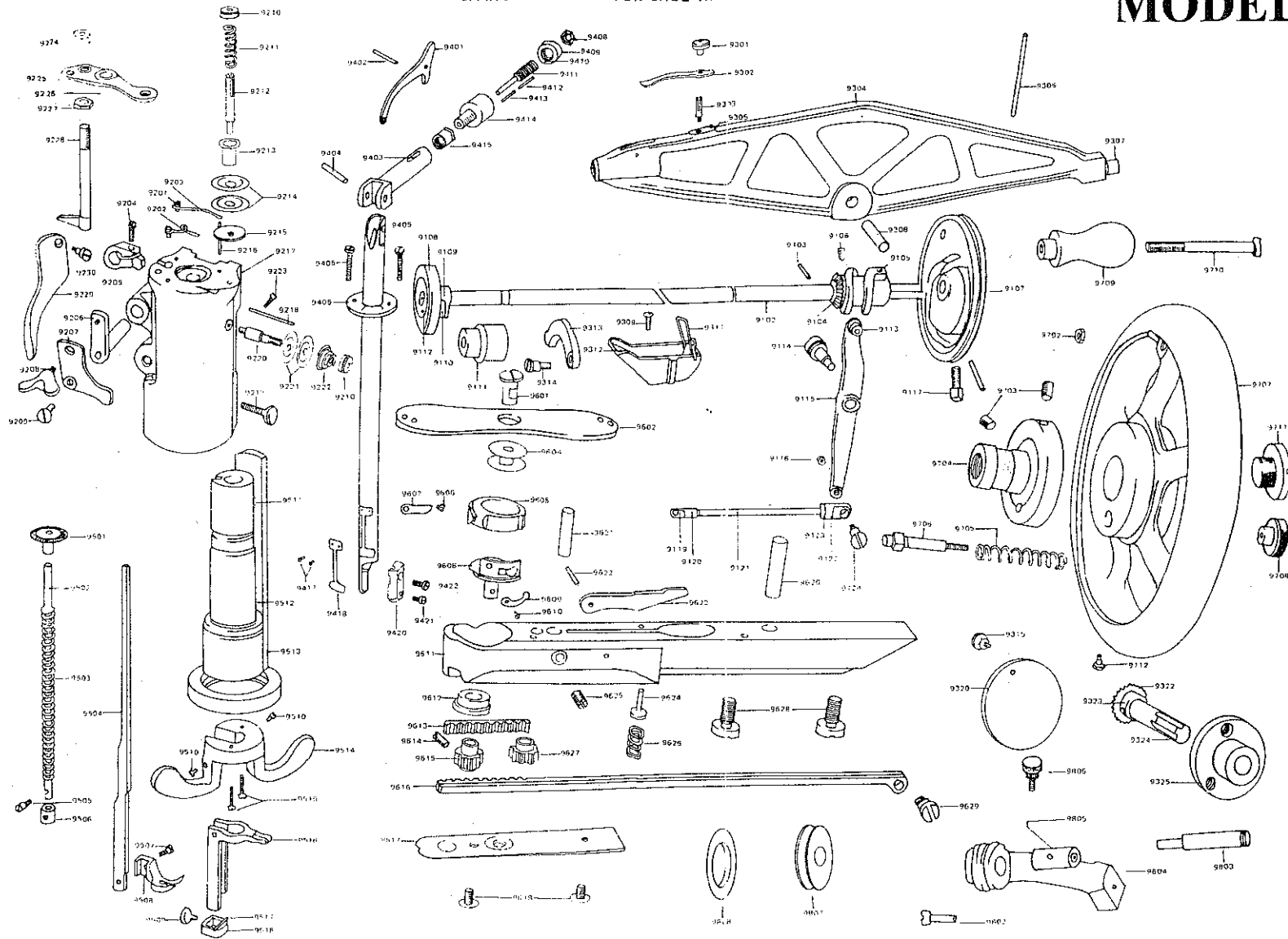

9101 - 9124
SHAFT, CAM WHEEL, SHUTTLE
DRIVING LEVER, PULLEY
WHEEL AND SHUTTLE DRIVING
LEVER CONNECTING ROD
ASSEMBLY

- 9101 Shuttle Driving Cam and Gear.
- 9102 Shaft.
- 9103 Pin.
- 9104 Gear.
- 9105 Shuttle Driving Cam.
- 9106 Screw.
- 9107 Needle Bar Cam and Pulley Wheel.
- 9108 Feed Motion Cam Wheel.
- 9109 Cam Wheel Pin.
- 9110 Roller.
- 9111 Shaft Bushing.
- 9112 Roller Pin.
- 9113 Roller and Stud.
- 9114 Bearing Screw.
- 9115 Shuttle Driving Lever.
- 9116 Eccentric Stud Nut.
- 9117 Cam and Pulley Wheel Set Screw.
- 9118 Shuttle Driving Lever Connecting Rod Complete, Nos.
- 9119 Connecting Rod End (front).
- 9120 Pin (front).
- 9121 Connecting Rod.
- 9122 Pin (back).
- 9123 Connecting Rod End (back).
- 9124 Eccentric Stud.

9201 - 9230
HEAD OF MACHINE AND
TENSIONS COMPLETE

- 9201 Screw.
- 9202 Thread Eyelet (head of arm).
- 9203 Friction Spring.
- 9204 Clamping Screw.
- 9205 Lifting Lever Shaft Lever.
- 9206 Lifting Lever Shaft.
- 9207 Lifting Lever Shaft Adjusting Lever.
- 9208 Clamping Screw.
- 9209 Hinge Screw.
- 9210 Tension Thumb Nut (2).
- 9211 Tension Spring.
- 9212 Adjusting Stud (top).

- 9213 Cup (release).
- 9214 Disc (2).
- 9215 Washer (leather).
- 9216 Friction Spring Pin.
- 9217 Head of Machine.
- 9218 Thread Guide Pin (side).
- 9219 Head Revolving Bush Stop Thumb Screw.
- 9220 Adjusting Stud (side).
- 9221 Disc (2).
- 9222 Tension (side) Spring.
- 9223 Head Binding Screw (4).
- 9224 Slide Rod Lock Nut (upper).
- 9225 Foot Bar Revolving Joint Bearing.
- 9226 Hinge Pin.
- 9227 Lock Nut (lower).
- 9228 Slide Rod.
- 9229 Lifter.
- 9230 Hinge Screw.

9301 - 9325
ARM SIDE COVERS, SHUTTLE
DRIVING AND LIFTING LEVERS

- 9301 Stud Nut.
- 9302 Spring.
- 9303 Spring Stud.
- 9304 Needle Bar Driving Lever.
- 9305 Spring Stead Pin.
- 9306 Spool Pin.
- 9307 Cam Roller and Stud.
- 9308 Joint Pin.
- 9309 Oil Cup Screw.
- 9310 Oil Cup with 8597 and 8695
- 9311 Spring.
- 9312 Oil Pad (cloth).
- 9313 Vibrating Presser Lifting Lever (for medium work).
- 9314 Lifting Lever Screw.
- 9315 Thumb Screw.
- 9320 Arm Side Cover (back).
- 9321 Hand Wheel Hub Complete, Nos. 11663, 81869, 82008 and 82052 for use when Hand Wheel is fitted on front of Machine.
- 9322 Hand Wheel Shaft Gear.
- 9323 Gear Pin.
- 9324 Shaft.
- 9325 Hub.

9401 - 9422
CHECK LEVER AND NEEDLE
BAR COMPLETE

- 9401 Check Lever.
- 9402 Joint Pin.
- 9403 Piston Joint.
- 9404 Joint Pin.
- 9405 Washer Screw (2).
- 9406 Head Revolving Bush Supporting Washer.
- 9407 Check Lever Thread Take-up Adjusting Screw with Indicator complete.
- 9408 Lock Nut.
- 9409 Index Head.
- 9410 Index Head Stop Pin.
- 9411 Adjusting Screw.
- 9412 Locating Plunger.
- 9413 Spring.
- 9414 Indicator Body.
- 9415 Indicator Body Lock Nut.
- 9416 Needle Bar complete.
- 9417 Needle Bar Complete.
- 9418 Spring Screw (2).
- 9419 Thread Tension Spring.
- 9420 Needle Bar Clamp.
- 9421 Needle Clamping Screw.
- 9422 Clamp Screw.

9501 - 9518
FOOT BAR AND FOOT BAR
REVOLVING JOINT

- 9501 Adjusting Nut.
- 9502 Spring Bar.
- 9503 Vibrating Presser Spring.
- 9504 Foot Bar.
- 9505 Collar Screw.
- 9506 Spring Bar Collar.
- 9507 Feeding Foot Screw.
- 9508 Feeding Foot

- 9509 Stitch Regulator Thumb Screw.
- 9510 Joint Screw (2).
- 9511 Roller and Stud.
- 9512 Revolving Bush.
- 9513 Slide Bar.
- 9514 Revolving Bush Handle.
- 9515 Handle Screw (2).
- 9516 Bell Crank Lever.
- 9517 Gib.
- 9518 Stitch Regulator.

9601 - 1629
NEEDLE PLATES, GEAR BOX
AND SHUTTLE COMPLETE

- 9601 Needle Plate Hinge Pin.
- 9602 Needle Plate (fine and medium needle holes).
- 9603 Shuttle complete.
- 9604 Bobbin.
- 9605 Shuttle Body.
- 9606 Tension Regulating Screw.
- 9607 Tension Spring.
- 9608 Shuttle.
- 9609 Spring.
- 9610 Spring Screw.
- 9611 Gear Box.
- 9612 Pinion Bushing.
- 9613 Rack (short).
- 9614 Pinion Screw.
- 9615 Driving Pinion.
- 9616 Rack (long).
- 9617 Pinion Cover Plate.
- 9618 Plate Screw (2).
- 9619 Needle Plate (medium and coarse needle holes).
- 9620 Following Pinion Stud.
- 9621 Gear Box Position Pin.
- 9622 Releasing Lever Hinge Pin.
- 9623 Releasing Lever.
- 9624 Locating Plunger.
- 9625 Needle Plate Hinge Pin Binding Screw.
- 9626 Plunger Spring.
- 9627 Following Pinion.
- 9628 Gear Box Screw (2).
- 9629 Connecting Rod Hinge Screw.

9701 - 9712
HAND WHEEL AND STOP
MOTION COMPLETE

- 9701 Hand Wheel and Stop Motion complete.
- 9702 Nut.
- 9703 Binding Screw (2).
- 9704 Hand Wheel Stop Motion Flanged Bushing.
- 9705 Spring.
- 9706 Stop Motion Plunger.
- 9707 Hand Wheel.
- 9708 Plunger Thumb Nut.
- 9709 Handle (wood).
- 9710 Spindle.
- 9711 Retaining Screw.
- 9712 Plunger Stop Screw.

9801 - 9808
BOBBIN WINDER COMPLETE

- 9801 Bobbin Winder complete.
- 9802 Frame Screw.
- 9803 Spindle.
- 9804 Frame.
- 9805 Eccentric.
- 9806 Eccentric Thumb Screw.
- 9807 Pulley.
- 9808 Rubber Ring.
- Spindle.

9851 - 9863
ACCESSORIES

- 9851 Oiler.
- 9855 Screw Driver (machine).
- 9856 Screw Driver (shuttle tension).
- 9857 Machine Screw (for fastening Machine to Power Table) (4).
- 9859 Machine Screw (for fastening Machine to Stand) (4).
- 9863 Threading Wire.