

V26, V28 MOTOR VERSION USER MANUAL

Speed Setting: Speed will appear on the screen when you turn on the motor. You can adjust speed by pressing + and - buttons.

Needle position Function: Press N button like a click and look at screen for needle position

UP= upward

dn= downward

(Needle synchroniser should be attached to use this function)

Restore Factory Setting: Long press N button for 5 seconds ,when to appears on screen release the button, settings restored.

Long press R button for 5 seconds to enter U Menu

-U0 XX(Here XX in any number from 5 to 70, each number is multiple of hundred and its maximum allowed speed that a user can access from + and - buttons without entering U menu). Adjust speed by + and - buttons, wait a moment when to appear on screen setting is done.

-U1 Its is to turn ON or turn OFF needle synchroniser functioning. Use + or - button to turn on /off wait for a moment when ot appears on screen its done. (*must turn it OFF when synchroniser is not attached otherwise motor will stop working and show error Err5).

-U2 is for rotational direction,
U2 0 Mean clockwise and U2 1 mean anticlockwise

Use + and - buttons to adjust, wait a moment when ot appear on screen setting is done.

-U3 The setting is require when you are using needle synchroniser and there is big difference between size of motor pulley and size of machine's pulley

U3 XX, Here XX can be any number between 9-88, when size difference is 1:3, increase number and see which setting fits you best and correct your needle position , lower the number the better it is, normal setting is 12. Use + and - to adjust.

-U4 XX(XX can be any number from 0 to 9.

U4 0 mean motor takes no time to start, 1-9 are adjusted to make some slow rotation in starting and then motor takes its normal adjusted speed, bigger the number the slower is start.

-U5 XX ,Here xx is any number from 0-9, 0 mean abrupt start, bigger the number the more delayed soft Strat, Usual value is U5 3. Value can be adjusted from + and - buttons.

U9

Use U9 1 ,if you are using speed reducing wheel

Use U9 0, in you are using motor directly to machine, if you are in this condition and your setting is U9 1 your mortor may continue to rotate and does not stop, change setting by + and - buttons.

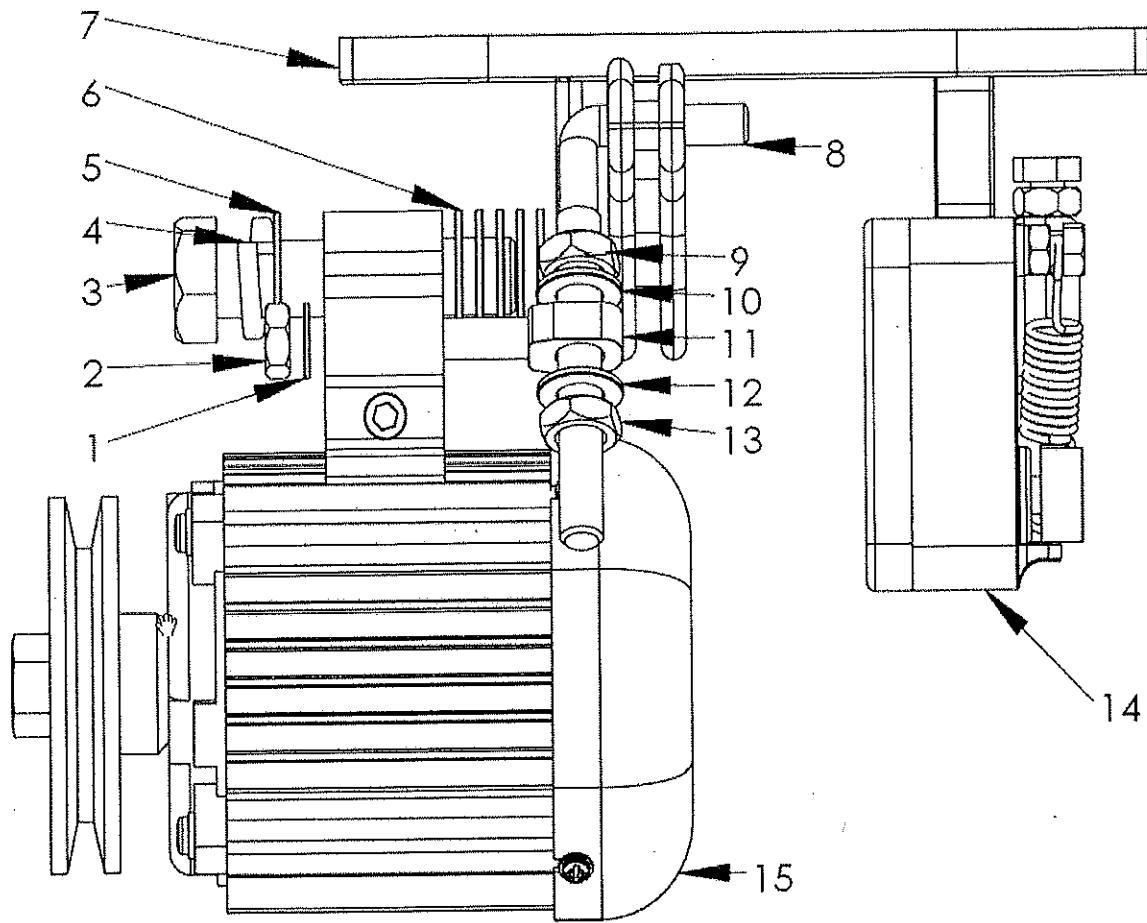

1-M8 平垫 Flat gasket

2-M8 螺母 Nut

3-M14 螺栓 Bolt

4-M14 弹垫 Spring gasket

5-M14 平垫 Flat gasket

6-M14x5 平垫 Flat gasket

7-底座 Bracket

8-L 螺栓 Bolt

9-M10 螺母 Nut

10-M10 平垫 Flat gasket

11-连接杆 Joint

12-M10 平垫 Flat gasket

13-M10 螺母 Nut

14-调速器组件 Speed controller group

15-电机组件 Motor group